

**vtech**<sup>®</sup>

# Parent's Guide

# ZoomiZooz<sup>®</sup>

## Swing



91-003702-004 

# INTRODUCTION

Thank you for purchasing the **VTech® ZoomiZooz® Swing**. Hippo loves to play on the swing! Place Hippo on the Magic ZoomiZone to hear fun responses, songs and sounds. Press the magic launcher to make hippo jump and spin onto the swing, swing the swing and hippo will jump out and tumble around!

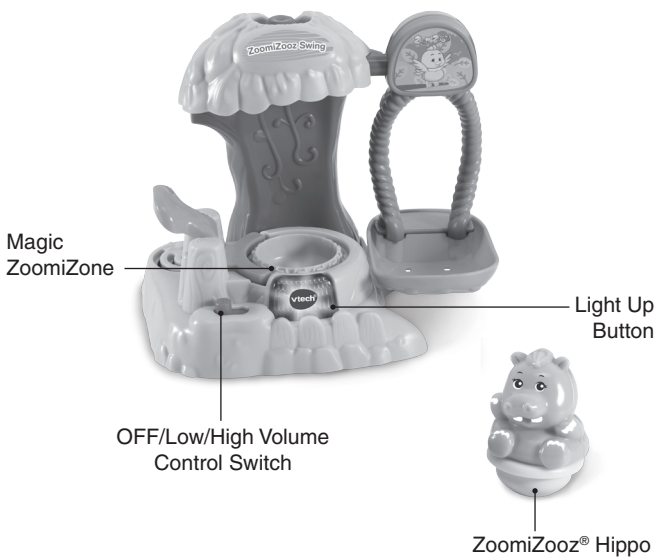

## INCLUDED IN THIS PACKAGE

- One VTech® ZoomiZooz® Swing
- One ZoomiZooz® Hippo
- One Parent's Guide

### **WARNING:**

All packing materials such as tape, plastic sheets, packaging locks, removable tags, cable ties and packaging screws are not part of this toy and should be discarded for your child's safety.

**NOTE:** Please keep this parent's guide as it contains important information.

**NOTE:** For your child's safety, do not aim at face or eyes when launching the ZoomiZooz® animals.

Please cut and discard the strings that attach the swing to the unit before playing.

### **Unlock the packaging locks:**

- ① Rotate the packaging locks 90 degrees anticlockwise.
- ② Pull out the packaging locks.

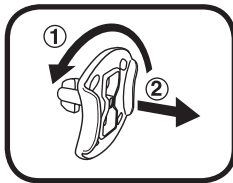

# GETTING STARTED

## BATTERY INSTALLATION

1. Make sure the unit is turned **OFF**.
2. Locate the battery cover on the bottom of the unit. Use a screwdriver to loosen the screw.
3. Install 2 new AAA (AM-4/LR03) batteries following the diagram inside the battery box. (The use of new alkaline batteries is recommended for maximum performance.)
4. Replace the battery cover and tighten the screw to secure.

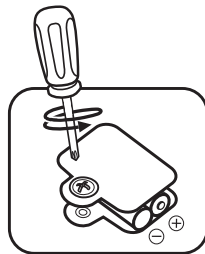

## BATTERY NOTICE

- Use new alkaline batteries or fully charged NI-MH (Nickel Metal-hydride) rechargeable batteries for best performance.
- Use only batteries of the same or equivalent type as recommended.
- Do not mix different types of batteries: alkaline, standard (carbon-zinc) or rechargeable, or new and used batteries.
- Do not use damaged batteries.
- Insert batteries with the correct polarity.
- Do not short-circuit the battery terminals.
- Remove exhausted batteries from the toy.
- Remove batteries during long periods of non-use.
- Do not dispose of batteries in fire.
- Do not charge non-rechargeable batteries.
- Remove rechargeable batteries from the toy before charging (if removable).
- Rechargeable batteries are only to be charged under adult supervision.

## Disposal of batteries and product



The crossed-out wheelee bin symbols on products and batteries, or on their respective packaging, indicates they must not be disposed of in domestic waste as they contain substances that can be damaging to the environment and human health.



The chemical symbols Hg, Cd or Pb, where marked, indicate that the battery contains more than the specified value of mercury (Hg), cadmium (Cd) or lead (Pb) set out in Battery Directive (2006/66/EC).

The solid bar indicates that the product was placed on the market after 13th August, 2005.

Help protect the environment by disposing of your product or batteries responsibly.



For more information, please visit:

[www.recycle-more.co.uk](http://www.recycle-more.co.uk)

[www.recyclenow.com](http://www.recyclenow.com)

## PRODUCT FEATURES

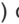
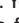
### 1. OFF/Low/High Volume Control Switch

To turn the unit **ON**, slide the **OFF/Low/High Volume Control Switch** to the **Low Volume** (  ) or the **High Volume** (  ) position. You will hear a song, a phrase and a fun tune. To turn the unit **OFF**, slide the **OFF/Low/High Volume Control Switch** to the **OFF** (  ) position.

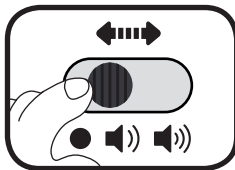

### 2. Automatic Shut Off

To preserve battery life, the **ZoomiZooz® Swing** will automatically shut-off after approximately 40 seconds without input. The unit can be turned on again by pressing any button or putting an animal on the Magic ZoomiZone.

**NOTE:** If the unit repeatedly shuts off quickly, we suggest changing the batteries.

## ACTIVITIES

1. Slide the **OFF/Low/High Volume Control Switch** to turn the unit on. You will hear a ZoomiZooz® song, phrase and a fun tune. The light will flash with the sounds.

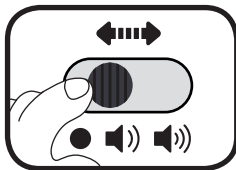

2. Press the **Light Up Button** to hear playful sing-along songs, fun phrases, sounds and melodies. The light will flash with the sounds.



3. Put an animal on the **Magic ZoomiZone** to learn about the animal and hear fun phrases, sounds and short tunes. The light will flash with the sounds.



4. For added fun the **VTech® ZoomiZooz® Swing** play set interacts with other **ZoomiZooz®** animals. Simply place a **ZoomiZooz®** animal into the **Magic ZoomiZone** on the Swing play set to see a flashing light and hear learning phrases and short tunes. (Play sets sold separately).

# SONG LYRICS

## Song 1

We are the ZoomiZooz.  
Welcome to our world!  
We bounce and swing, roll and jump.  
It's so much fun!  
It'll be an adventure,  
exploring all the way.  
Come along and join us ZoomiZooz! (ZoomiZooz!)

## Song 2

Swing up, swing down, swing around all day long!  
Come and play with me, my friend, it'll be so much fun!

## Song 3

Hello birdie sitting in the tree.  
Hello hippo wobbling on the swing!  
Our friends are coming to play  
Wobbling along the way!

# MELODY LIST

1. Aiken Drum
2. Animal Fair
3. Jack & Jill
4. Old Grey Mare
5. Farmer in the Dell
6. Shoo Fly Don't Bother Me
7. Alouette
8. Ring around the Rosy
9. Pop goes the Weasel
10. Humpty Dumpty
11. Three Little Kittens
12. Turkey in the Straw
13. Mulberry Bush
14. Bingo
15. Bill Bailey



## CARE & MAINTENANCE

1. Keep the unit clean by wiping it with a slightly damp cloth.
2. Keep the unit out of direct sunlight and away from any direct heat source.
3. Remove the batteries when the unit will not be in use for an extended period of time.
4. Do not drop the unit on hard surfaces and do not expose the unit to moisture or water.

## TROUBLESHOOTING

If for some reason the unit stops working or malfunctions, please follow these steps:

1. Please turn the unit **OFF**.
2. Interrupt the power supply by removing the batteries.
3. Let the unit sit for a few minutes, then replace the batteries.
4. Turn the unit **ON**. The unit should now be ready to play again.
5. If the product still does not work, replace with an entire set of new batteries.

If the problem persists, please call our Consumer Services Department and a service representative will be happy to help you.

## CONSUMER SERVICES

Creating and developing VTech products is accompanied by a responsibility that we at **VTech®** take very seriously. We make every effort to ensure the accuracy of the information, which forms the value of our products. However, errors sometimes can occur. It is important for you to know that we stand behind our products and encourage you to call our Consumer Services Department with any problems and/or suggestions that you might have. A service representative will be happy to help you.



UK Customers:

Phone: 0330 678 0149 (from UK) or +44 330 678 0149 (outside UK)

Website: [www.vtech.co.uk/support](http://www.vtech.co.uk/support)

Australian Customers:

Phone: 1800 862 155

Website: [support.vtech.com.au](http://support.vtech.com.au)

NZ Customers:

Phone: 0800 400 785

Website: [support.vtech.com.au](http://support.vtech.com.au)

## **Product Warranty / Consumer Guarantees**

UK Customers:

Read our complete warranty policy online at [vtech.co.uk/warranty](http://vtech.co.uk/warranty).

Australian Customers:

**VTECH ELECTRONICS (AUSTRALIA) PTY LIMITED – CONSUMER GUARANTEES**

Under the Australian Consumer Law, a number of consumer guarantees apply to goods and services supplied by VTech Electronics (Australia) Pty Limited. Please refer to [vtech.com.au/consumerguarantees](http://vtech.com.au/consumerguarantees) for further information.

**CLASS 1  
LED PRODUCT**



**Visit our website for more  
information about our products,  
downloads, resources and more.**

***[www.vtech.co.uk](http://www.vtech.co.uk)***  
***[www.vtech.com.au](http://www.vtech.com.au)***



TM & © 2019 VTech Holdings Limited.  
All rights reserved.  
**Printed in China.**  
91-003702-004 